



- Standard Description -

445



DUFOUR | 445
Grand'Large

- Standard Description - DUF0UR 445 *Grand'Large* - September 2011 -



DUFOUR
YACHTS

DUFOUR | 445

Grand'Large

>>> TECHNICAL SPECIFICATIONS >>>

Designer:	Umberto Felci
LOA:	13.5 m
Hull length:	13.25 m
LWL:	11.92 m
Beam:	4.34 m
Displacement (empty) with deep keel:	10,126 Kg
Draft with deep keel:	2.20 m
Draft with short keel:	1.95 m
Ballast weight (short keel.):	3,000 Kg
Ballast weight (long keel):	2,850 Kg
Air draft:	18.40 m
Fuel capacity:	250 L
Fresh water capacity:	570 L
Engine power:	55 hp (40 kW)

>>> SAIL AREA >>>

Total sail area:	98.50 m ²
Mainsail:	43.50 m ²
Genoa (140%):	50.50 m ²

>>> SAIL PLAN >>>

I (long mast):	15,8 m
J :	5 m
P (long mast):	14,85 m
E :	5,1 m
LP (140 %)	7 m

>>> CONSTRUCTION >>>

- Hand laminated GRP hull.
- Gelcoat with first layer impregnated with NPG resin to create an optimum osmotic barrier.
- Counter - moulded hull, structural grid laminated to

the hull. Injection-moulded deck with PVC foam core offering significant weight saving and a perfect interior finish.

- Cast iron ballast; keel bolted to the hull with stainless steel counter plates.
- Semi-elliptical rudder blade filled with closed-cell foam. Solid stainless steel stock.

>>> DECK HARDWARE >>>

- Genoa tracks with lead cars.
- 2 genoa sheet return blocks on coamings.

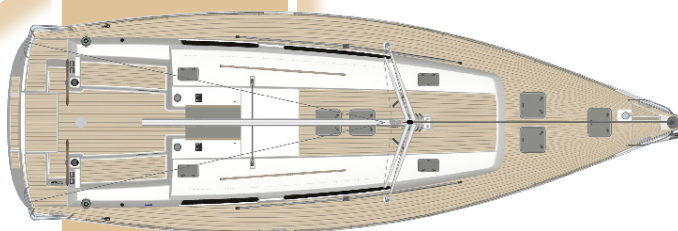

- 2 port and starboard deck organizers with flat mounted sheaves for return of halyards, mainsail sheet, reefing lines, and running rigging lines.
- Stainless steel through-deck swan necks for electric and electronic wiring.
- Roof mounted clam cleats.
- Roof mounted halyard winches.
- 2 genoa sheet winches on coamings near helm console.
- Solid wood railings on cabin roof top.
- Solid wood toe rails.
- Self-draining anchor locker with locker clench and built-in windlass support, with locking hatch
- Stem head fitting with 2 bow rollers.
- Pulpit with seat and separate green/red LED navigation lights.
- Stern pulpits with horseshoe buoy bracket, flag pole fitting, navigation lights, life-lines with snap hook opening.
- 10 stanchions with double life-lines.
- 6 aluminum mooring cleats.
- 2 stainless steel chain plates for backstays, lower and

mid shrouds.

- 2 backstay chain plates.
- 2 water tank fillers and 1 fuel tank filler.
- Mainsail track on roof top with adjustable car. Boom vang with tackle.

>>> COCKPIT >>>

- Teak covered cockpit benches and helm seat.
- Non-skid polyester cockpit floor.
- 2 large side lockers with hatches equipped with lighting jacks and padlock fittings.
- Polyester steering wheel consoles.
- Rudder stock head located under the helmsman station for emergency tiller installation.
- Controls and engine panel on starboard steering station.
- Tilting rear hatch door with built-in telescopic swim ladder.
- Gas bottle storage in aft starboard locker.
- Lifeboat storage in dedicated compartment under aft hatch.
- Cockpit shower head.
- 2 wooden footrests.
- Removable tank under port helm seat.
- Storage compartment under starboard helm seat.

>>> RIGGING AND SAILS >>>

- Anodized aluminum deck-stepped mast with double swept-back spreaders.
- Anchor and steaming lights. Deck floodlight.
- Cleat for boom topping lift.
- Anodized aluminum boom fitted with two automatic mainsail reefing lines.
- genoa furler.
- Continuous-type standing rigging with single-strand stainless steel cable and chrome-plated bronze turnbuckles including forestay, intermediate and lower shrouds.
- Running rigging in pre-stretched textile lines: mainsail and genoa halyards, boom topping lift, mainsail and genoa sheets, 2 automatic reefing lines, outhaul line, 2



lines for mainsheet car control, furling line, boom vang tackle.

- Mainsail has two broad reef bands and battens. Furling genoa with UV protection.
- Stainless steel mast pillar.

>>> VENTILATION AND LIGHTING >>>

- Excellent ventilation provided by:
- 8 deck hatches fitted curtains and 4 mushroom-type vents insuring permanent ventilation.
- 8 hull ports, 4 fixed roof ports and 3 opening ports with curtains.
- Electrical lighting provided by chrome finished overhead lights and reading lights.

>>> INTERIOR >>>

- All the woodwork is made of first grade Moabi mahogany. The gunwales, moldings and edges are made of solid wood and veneers.
- All cabin doors are equipped with spring bolts and an anti-vibration locks with an open-position blocking system and vents.
- Laminate Moabi-style floorboards.
- Saloon cushions and mattresses with removable fabric covers.
- The cabins' lining is made of wood (marine grade) with a white lacquered finish.

>>> COMPANIONWAY >>>

- Sliding Plexiglas hatch and door with stoppers and lock.
- Curved teak steps.
- 2 handrails.
- A wooden hinged hatch with lift jacks covers the engine access.
- Special exterior storage location for companionway door.

>>> SAIL LOCKER >>>

- Access through T60 hatch panel with vent.
- Large storage volume with floorboards.

>>> FORWARD CABIN >>>

- Large berth, 200 x179 cm (approx.).
- 10 cm thick foam mattress with washable cover.
- Freshwater tank 180 L. (approx.)
- Storage locker under berth.
- Locker along hull side.
- 2 hanging lockers with shelves.
- 2 drawers for small items
- Access to navigation instrument sensors.
- 1 large drawer below berth.
- Tall mirror.
- Coat peg.
- Cabinet on front bulkhead with mirror.

>>> FORWARD STARBOARD INDEPENDANT TOILET >>>

- Manual marine toilet.
- Storage facilities.
- Toilet paper holder.
- Access to toilet thru-hulls via latch.

>>> FORWARD PORT WASHROOM >>>

- Sink cabinet "Corian®" top.
- Polyester sink with hot/cold mixer tap made of chromed brass.
- Storage facilities with sliding hatch that can be used as an oilskins locker.
- Large mirror.
- Electric shower sump pump.
- «Corian®» (synthetic resin) duckboards.

>>> SALOON >>>

- Large U-shape lounge banquette to port.
- Foam backs and seats with washable covers.

- Fixed settee (mobile on option).
- Storage under the banquette.
- Large saloon table fitted with a removable latch and a "Corian®" crumb collector.
- Storage under seats and behind banquettes' backs.
- Closets, shelving, bookcase and bar above banquette.

>>> GALLEY >>>

- Galley with large countertop made of "Corian®" synthetic resin and wooden surround.
- Longitudinal layout.
- Double-basin stainless steel sink. Chrome-plated mixer tap with pressurized hot and cold water.
- Gimbale gas stove 2 burners/ oven.
- Very large 12 V fridge (180 L) with access from countertop and front.
- 5 drawers with automatic rails.
- Open or closed cabinets.
- Microwave oven compartment (optional) in cabinet.
- Crumb collector under floorboards.
- Corian®"cover tilting over the cooker top.

>>> CHART TABLE >>>

- Large size chart table with opening desk top and lap-top slot.
- Wooden hinged seat with storage.
- Leatherette cushion.
- Instrument console.
- 12V electrical panel along the chart table.
- Storage cabinet with 1 drawer under the chart table.
- Cabinets with doors above electrical panel.
- Open storage compartment.

>>> AFT CABINS >>>

- Starboard aft cabin
- Double berth, approximately 202 x 144 cm.
- Foam mattress 10 cm thick with washable cover.
- Large hanging locker with shelf and double door.
- Storage unit in front of hanging locker and in the centre compartment.





- Cabinet along hull.
- Fuel tank.
- Coat peg.
- Port Aft Cabin
- Double berth 202 x 160 cm, approx (with generator: approx 202 x 144 cm).
- 10 cm thick foam mattress with washable cover.
- 2 lockers in center compartment.
- Large hanging locker with shelf and double door.
- Locker along the hull.
- Water tank.
- Coat peg.
- Battery switch on technical module.

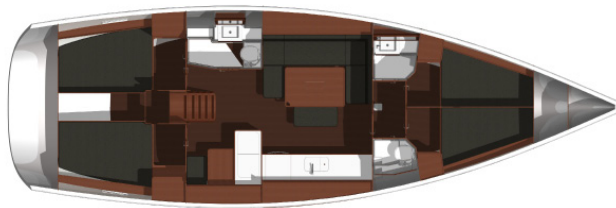

- Direct access to aft washroom.

>>> AFT WASHROOM >>>

- Access from saloon or port aft cabin.
- Manual marine toilet.
- Wash basin cabinet with synthetic "Corian®" top.
- Polyester sink with hot/cold mixer tap in chrome brass.
- Storage with sliding door that can double as an oilskins locker.
- Large mirror.
- Shower with electric sump pump.
- Oilskins hanging locker in polyester with Plexiglas

door.

- «Corian®» synthetic resin duckboards.

>>> ENGINE >>>

- VOLVO 55 hp (40 kW) Sail drive transmission.
- Heat exchanger, anti-siphon valve.
- Engine control panel with hour meter, engine shut-off and rev counter.
- Generator with load dispatcher.
- 250 L tank (approx), gauge on electric panel.
- Fuel filter with water separator.
- Emergency fuel cut-off valve.
- Ventilation through two natural inlets and forced extraction by an electrical extractor.
- Fixed two-blade propeller.
- Access to the engine from the front and from both sides. Separate engine drip tray.
- Soundproofing with quality foam lining.

>>> PLUMBING >>>

- Polyethylene water tanks with inspection latches and electrical gauges.
- Pressurized water unit. 40 L water heater.
- Electrical bilge pump with filter and control switch on electrical panel.
- Manual bilge pump operated from the cockpit.
- Sump integrated into keel with access to strainer.
- Overboard drainage of shower water by electric pump.

>>> ELECTRICITY >>>

- 12 V system. Electrical panel with circuit breakers, voltmeter and 12 V outlet.
- 100 Ah engine battery. 100 Ah house battery.
- Battery master switch for each circuit.

>>> MISCELLANEOUS >>>

- 2 winch handles with casing.
- Owner brief case with user manual.
- Grounding of the rigging.



DUFOUR YACHTS
1 rue Blaise Pascal
FR - 17187 PERIGNY
www.dufour-yachts.com

The descriptions and illustrations given are for information only.

Our models may be subject to certain production improvements or modifications without notice.



DUFOUR
YACHTS

